

# FOLDING PORTABLE DISPLAY SNEEZE GUARD

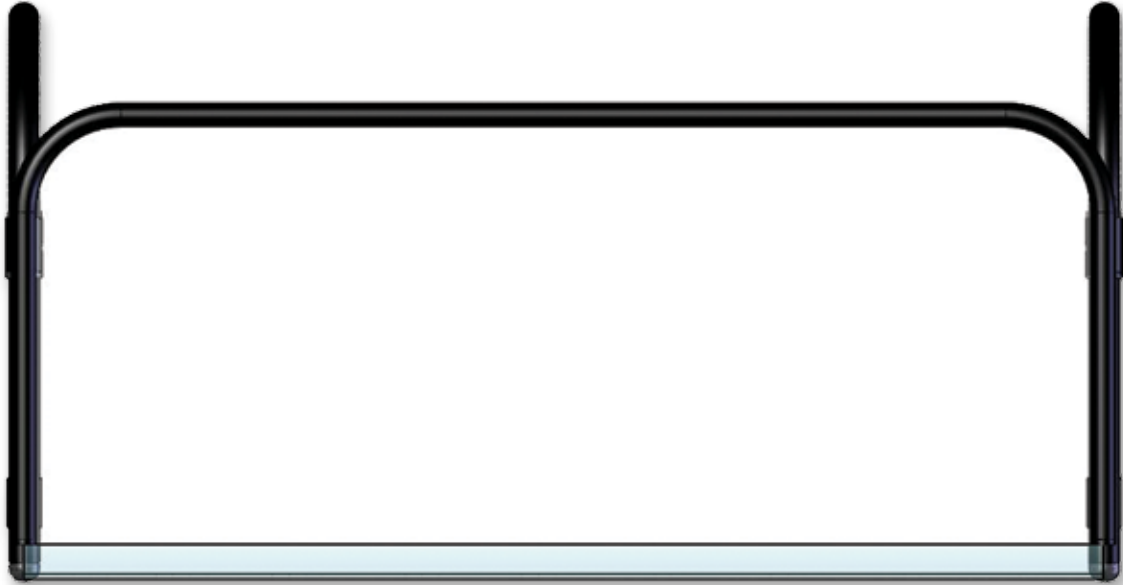

*Meets Service and Self-Service Requirements*

DISPLAY GUARD

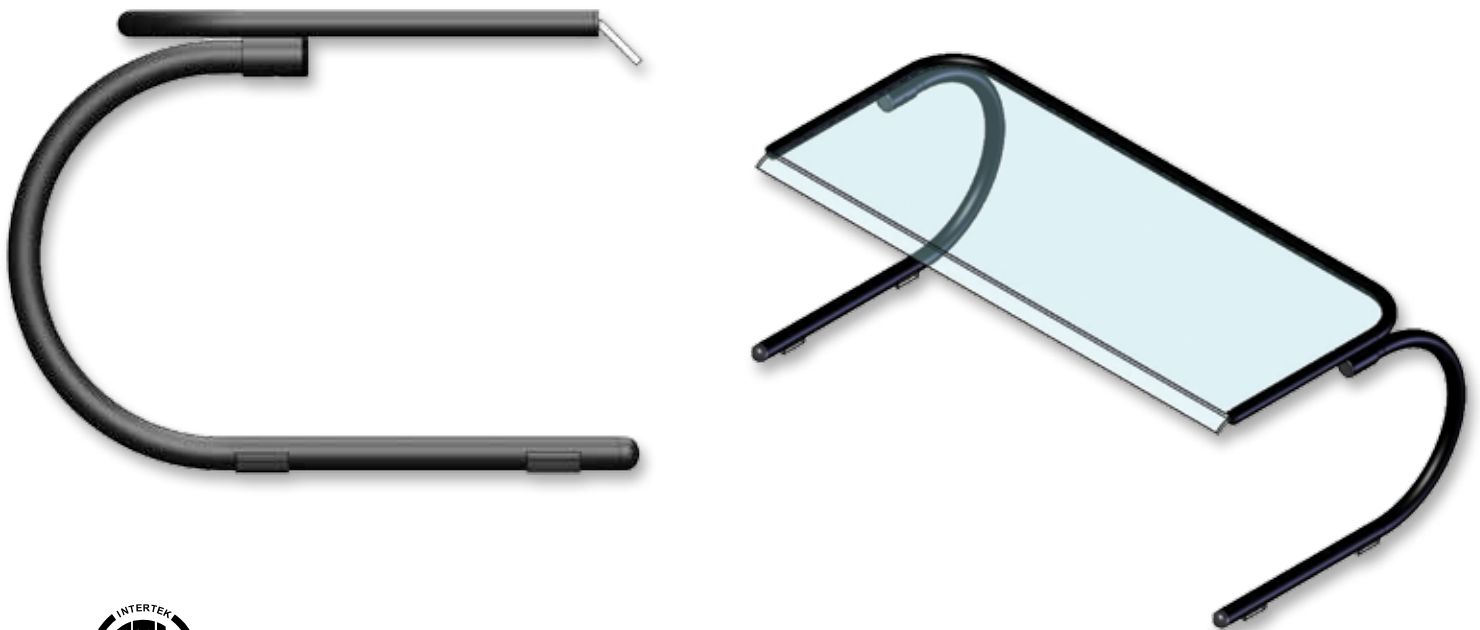

ANSI/NSF 2

\* Images are computer renderings, not actual photos, some color variance may occur from what is rendered to the actual powder coat finish.

Phone: 800-569-2056  
Fax: 573-449-7126  
[www.sneezeguardsolutions.com](http://www.sneezeguardsolutions.com)

# SPECIFICATIONS

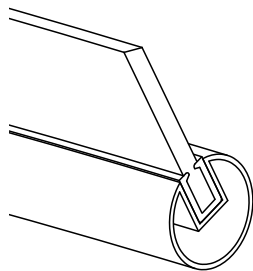
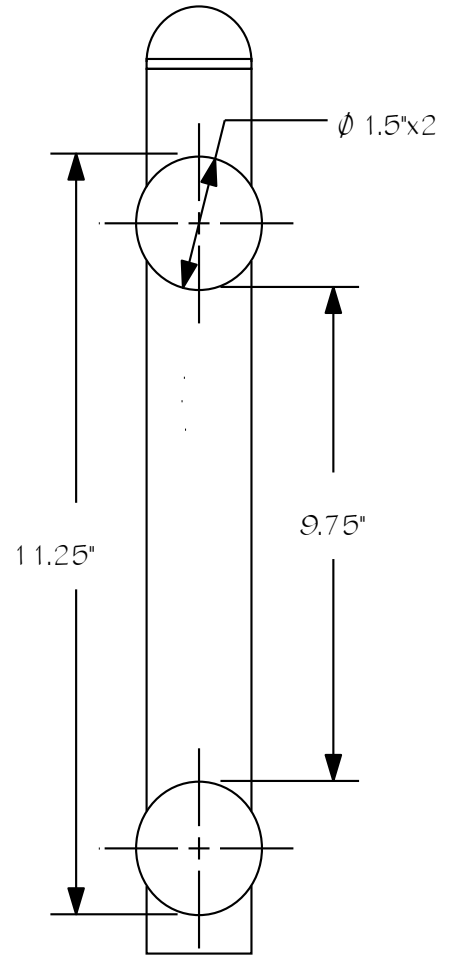
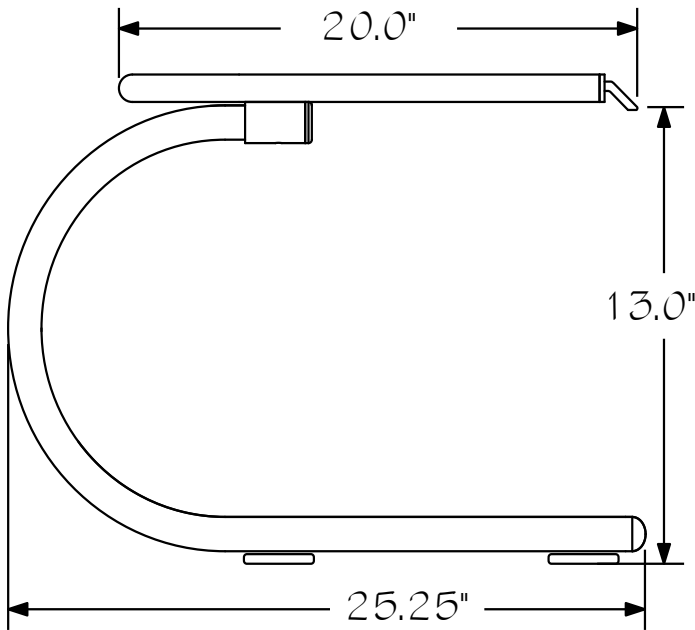

- *Exclusive extruded 1" Groove Tube*
- *Mounted in rubber gasket*
- *1.25" aluminum stands*
- *Powder coated finish*

<i>Black</i>	<i>Nominal Length</i>	<i>Overall Length</i>	<i>Between Stands</i>	<i>Weight</i>
<i>0841</i>	<i>2 foot*</i>	<i>25.5"</i>	<i>20.5"</i>	<i>8 lbs</i>
<i>0941</i>	<i>3 foot*</i>	<i>34.75"</i>	<i>29.75"</i>	<i>9 lbs</i>
<i>1041</i>	<i>4 foot</i>	<i>46.75"</i>	<i>41.75"</i>	<i>10 lbs</i>
<i>1141</i>	<i>5 foot</i>	<i>58.75"</i>	<i>53.75"</i>	<i>13 lbs</i>
<i>1241</i>	<i>6 foot</i>	<i>70.75"</i>	<i>65.75"</i>	<i>14 lbs</i>

*\*One leg does not lock in a closed position due to short length of guard.*